

TÜV
AUSTRIA

CERTIFIED
EN ISO 9001
CERTIFICATE NO. 20 100 122087152
TÜV AUSTRIA CERT GMBH

QUICK CHANGE TOOL POST WITH MULTI TOOL HOLDERS

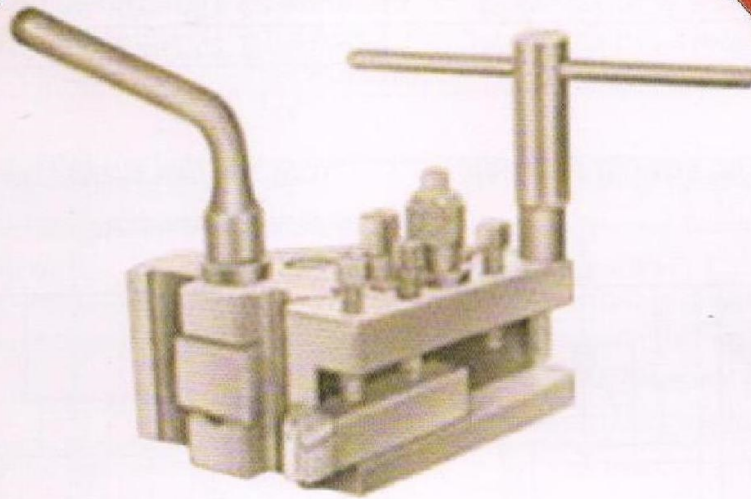

- Increase Productivity
- Control Quality Parameters

- Minimize Setting Time
- Repeatability & Long Life

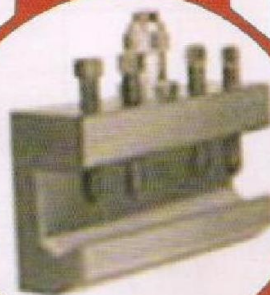
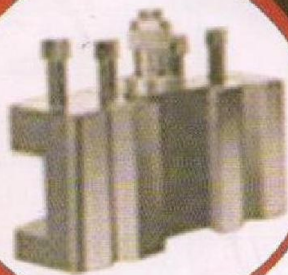

Basic Specifications are:

Model	Tool Shank Size	Suitable for Lathe
H.P 075	12 mm sq to 20 mm sq	G.D. Weiler & bench type lathe
H.P 150	15 mm sq to 25 mm sq	Centre HT 150 - 180 mm & upto 3 HP
H.P 210	20 mm sq to 32 mm sq	Centre HT 180 - 250 mm & upto 15 HP
H.P 315	20 mm Sq to 40 mm Sq	Centre HT 250 to 350 mm, Bombay Lathe

TOOL HOLDER SHOWN ON LOWEST POSITION

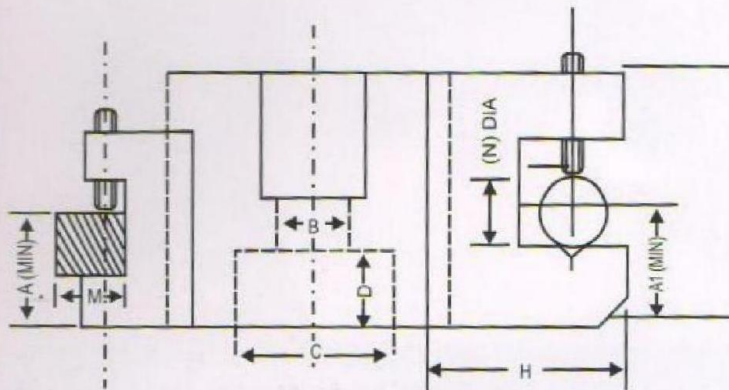

TOOL HOLDER SHOWN ON HIGHESEST POSITION

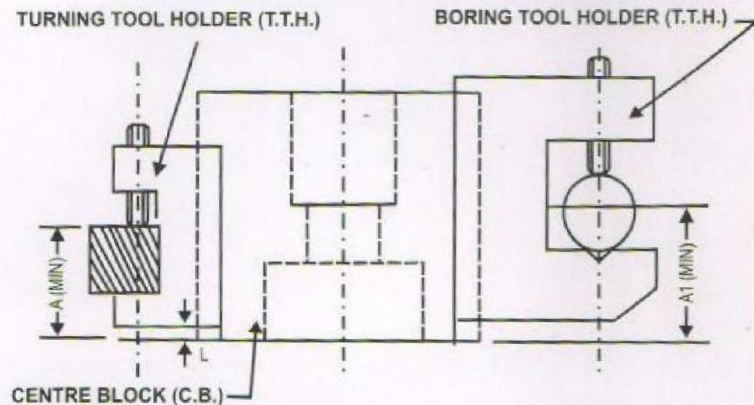

Dimensions Specifications Chart

Model	Tool Shank Size		A for TTH		A for BTH		L (Lift)	B Dia. Max.	C Dia. Max.	D Max.
	Turning M.Sq.	Boring N. Dia	Min.	Max	Min.	Max.				
HP075	16 x 16	12	28	34	19	24	8	12.5 H7	12 H7	27
	12 x 12	8	24	30	16	22				
HP150	25 x 25	20	39	47	21	29	8	20 H7	50	15
	15 x 15	16	29	37	18	26				
HP210	32 x 32	25	46	58	37	49	12	22 H7	38	30
	20 x 20	20	34	46	33	45				
HP 315	32 x 32	30	56	76	40	60	20	25	44	35
	40 x 40	40	64	84	44	64				

Model	Center Block (L x B x H)	TTH (H x B x L)	BTH (H x B x L)
HP210	132 x 132 x 82	70 x 45 x 140 Long	70 x 45 x 140 Long
HP150	111 x 111 x 63	55 x 40 x 110 Long	55 x 40 x 110 Long
HP075	96 x 96 x 53	47 x 32 x 100 Long	37 x 47 x 100 Long
HP315	170 x 170 x 110	60 x 90 x 180 Long	60 x 90 x 180 Long

Material Specifications Chart:

	Main Body	Turning Tool Holder / Boring Tool Holder	Bend & T-Handle	Tool Clamping Bolts
Material	S.G. Iron Casting	EN32 B / 20MnCr5	EN8	EN8
Heat Treatment	Case Hardened to 1.0 to 1.5 mm	Case Hardened to 0.6 to 0.8 mm	Toughened	Toughened
Hardness	54 to 60 HRC	54 to 58 HRC	30-35 HRC	30-35 HRC

Features:

- | | |
|--|--|
| <ol style="list-style-type: none"> 1. Tool Changing within split second 2. Guaranteed Tool positioning accuracy within 0.005 mm 3. Parts made of alloy steel 4. Hardened and Ground ensuring long life | <ol style="list-style-type: none"> 5. Number of extra operation possible with pre-set tools and special accessories 6. Increased productivity 7. Minimum setting time 8. Controlled quality parameters 9. Repeatability & long life |
|--|--|



Drilling Tool Holder



Parting Tool Holder

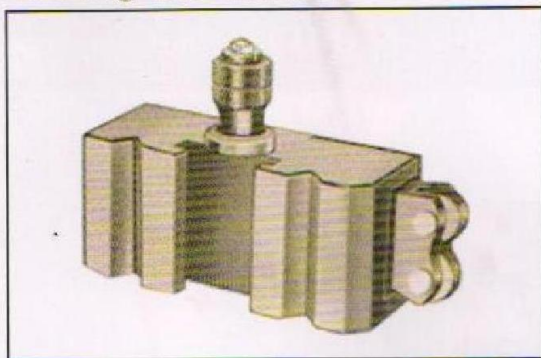

Knurling Holder

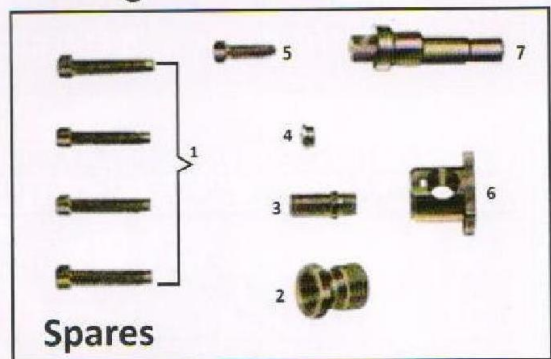

Spares

1. Square Head Bolts –M10 x 50 / M10 X 40 –Set of 4
 2. Thimble, 3. Ferrule, 4. Step Washer, 5. Square Head Bolt –M8 x 32, 6. Clamping Piece, 7. Eccentric Pin
- Height Adjustment Assembly –Assembly of 2, 3, 4 & 5

Suitability Chart

HP - 150

Suitable for

Kirloskar Hi-Cut Mafras GD 1 D2, Enterprises 1330, PSG 141, Tiger GD Weiler, Energy, GMM2, MMM 170 Series, New Dilip 162 mm, Model 1 & 2, Ganesh Machines, Anil Model 1 to 4 Lathes Venus HG 31, Venu HG 41, Sukan SU-37 & all 4½ Lathes.

HP - 210

Suitable for

HMT Vikram, Qetkos Chamundi, LB 17, 22, 26 NL 22, 26, PSG 124, Kirloskar Simoga Enterprises 1550, 1675, 1810, 2215, Sagar, Atul No 1 to 4, MMM 200 Series Nagmati, Sharad 1 & 2 Lathes, Sukun SU - 41, Venus HG 50 and all similar medium & heavy sized lathes.

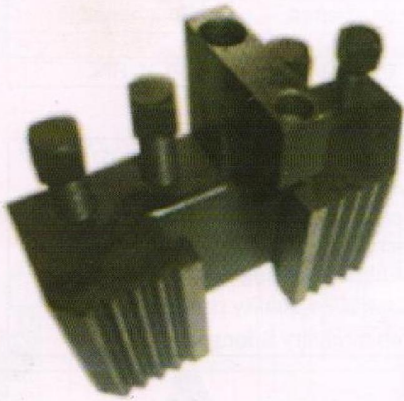

Special Copying Tool Holder



Special Boring Bar Holder

Instructions and Details required for Selection of QCTP model

TYPICAL DIMENSIONS OF STANDARD SQUARE TOOL POST OF LATHE

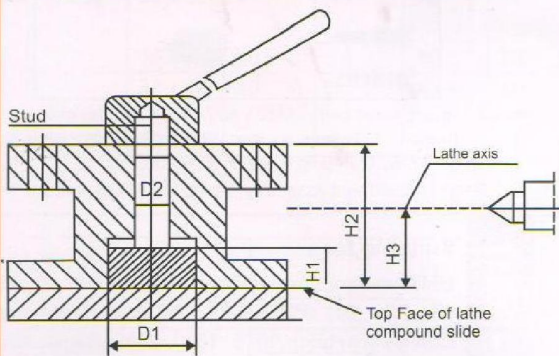

1. Specify Make, Model of Center Lathe for which QCTP is needed
2. Specify Center Height of Lathe
3. Specify Horse Power of lathe
4. Measure D1 with micrometer and specify
5. Measure D2 with micrometer and specify
6. Mention H1, H2 and H3 correctly

INDEXING & NON INDEXING COLLET FIXTURES & MILLING FIXTURES

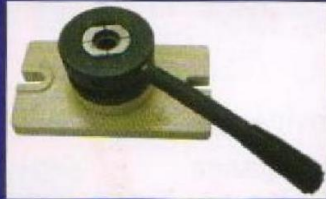

MOST VERSATILE & ACCURATE

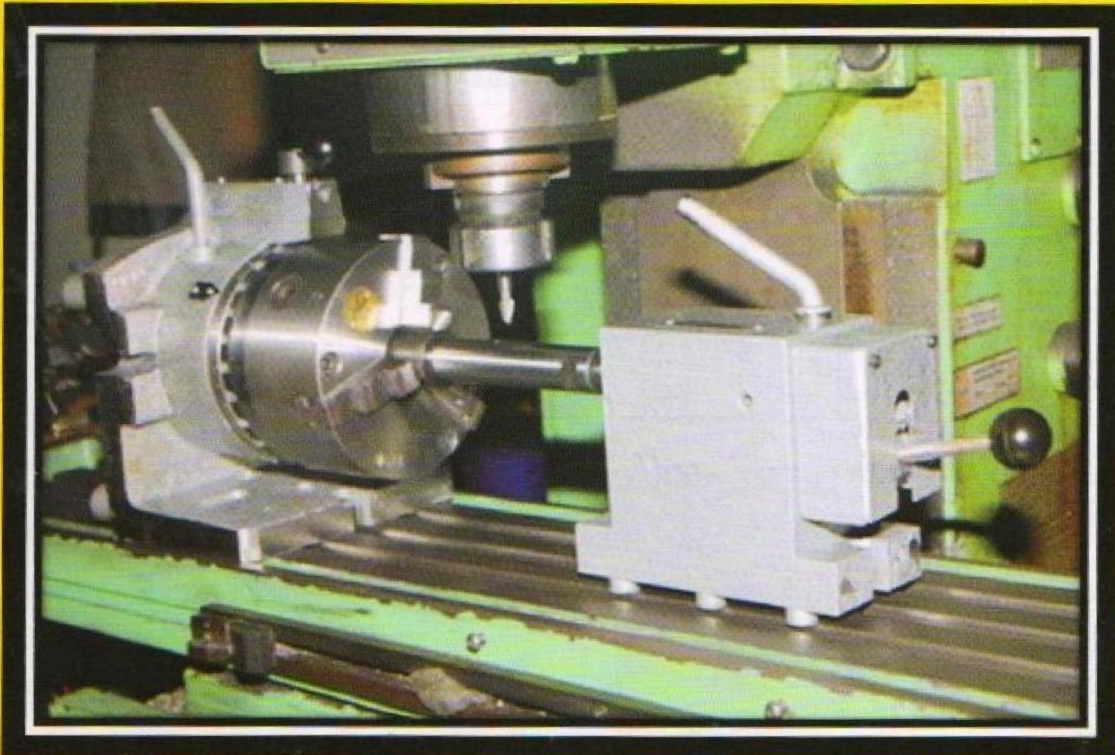

NON-INDEXING FIXTURES

Features:

- Split Second concentric clamping & unclamping of job
- Most versatile applications
- Long Life
- Ideal & Efficiency booster for mass production
- Step Collets / Square / Hex or Profile Collets can be provided

Horizontal - Vertical - light milling / drilling – Economical Range

Sr. No.	Model No.	Mounting	Length (mm)	Width (mm)	Height (mm)	Maximum Holding Diameter
1	CFHV A-25 Eco	Collet Mounting	110	100	90	4 to 25 mm
2	CFHV A-42 Eco		125	105	105	4 to 42 mm



Collet Fixture – For heavy milling / drilling operations

Sr. No.	Model No.	Length (mm)	Width (mm)	Height (mm)	Maximum Holding Diameter
1	CFA-25	170	115	110	4 to 25 mm
2	CFA-42	225	130	110	4 to 42 mm
3	CFA-60	270	155	145	5 to 60 mm

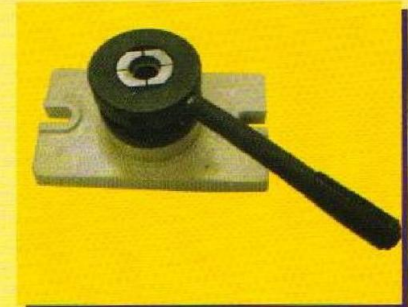

Horizontal Vertical – For heavy milling & drilling operations

Sr. No.	Model No.	Mounting	Length (mm)	Width (mm)	Height (mm)	Maximum Holding Diameter
1	CFHV A-25	Collet Mounting	200	110	110	4 to 25 mm
2	CFHV A-42		200	110	110	4 to 42 mm
3	CFHV-80 /100/ 125	100 mm Chuck Mounting	200	110	110	Any size upto 125 mm Dia



DIFFERENT APPLICATIONS

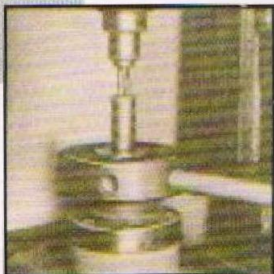

Tapping

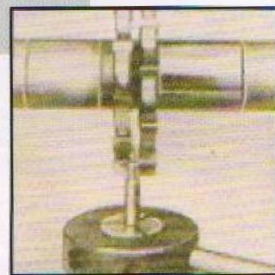

Gang Milling



Slotting

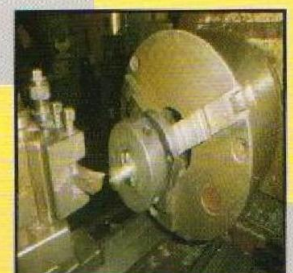

For Turning on Lathe

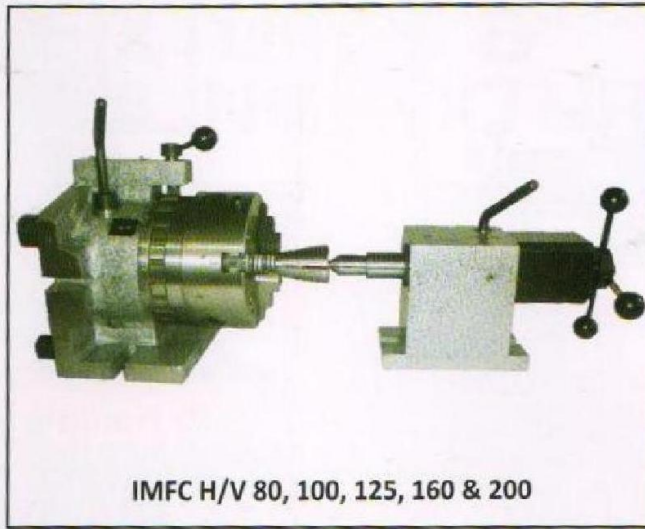

IMFC H/V 80, 100, 125, 160 & 200



ICF A25 / A 42 (HP)

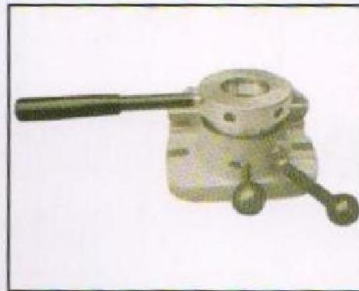

ICF H/V A42 Eco



ICF H/V A25 / A 42

Sr. No.	Model No.	Length (mm)	Width (mm)	Height (mm)	Std. Indexing Positions	Center Height (mm)	Approx. Weight	Features	Indexing Accuracy
1	ICF H/V A25	200	110	180	24	85	24 kg	Double Bearing Mounted With Tailstock Suitable for A25 Collet	0.025 mm
2	ICF H/V A42	200	110	180	24	85	25 kg	Double Bearing Mounted With Tailstock Suitable for A42 Collet	0.025 mm
3	IMFC H/V 080	200	110	180	24	85	27 kg	Double Bearing Mounted 80 mm chuck mounted With Tailstock	0.03 mm / 15 sec
4	IMFC H/V 100	200	110	180	24	85	27 kg	Double Bearing Mounted 100 mm chuck mounted With Tailstock	0.03 mm / 15 sec
5	IMFC H/V 125	200	110	180	24	85	27 kg	Double Bearing Mounted 125 mm chuck mounted With Tailstock	0.03 mm / 15 sec
6	IMFC H/V 160	200	145	240	24	120	45 kg	Double Bearing Mounted 160 mm chuck mounted With Tailstock	0.03 mm / 15 sec
7	IMFC H/V 200	200	145	240	24	120	48 kg	Double Bearing Mounted 200 mm chuck mounted With Tailstock	0.03 mm / 15 sec
8	ICFA25 (HP)	270	150	140	2-Square, 3-Hex	NA	12 kg	Vertical Mounting Suitable with A25 collet For Square & Hex milling	0.02 mm / 10 sec.
9	ICFA42 (HP)	270	150	140	2-Square, 3-Hex	NA	13 kg	Vertical Mounting Suitable with A42 collet For Square & Hex milling	0.02 mm / 10 sec.
10	ICF-H/V-A42 Eco	150	110	100	12	NA	8 kg	Vertical mounting Suitable for A42 collet	0.03 mm / 15 sec

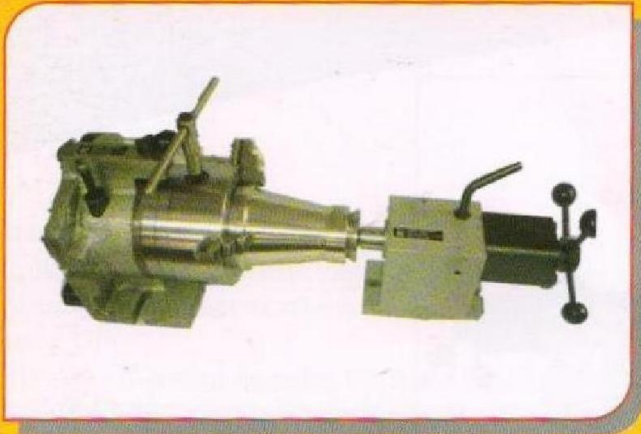

Index Milling with Special Chuck



ID Holding with Job Location

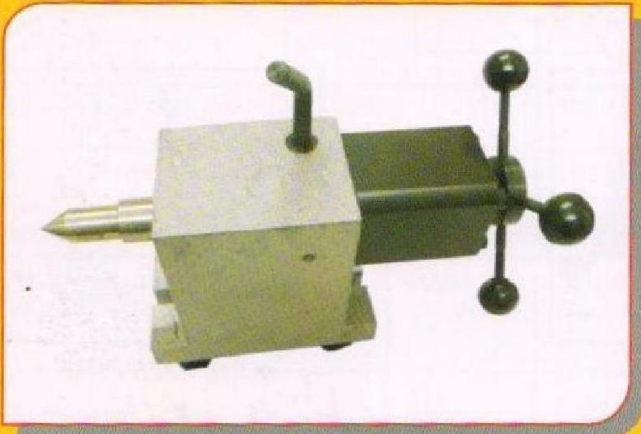

Custom Made Tailstock



Indexing for P.C.D. Holes



Indexing Plate (Hardened & Ground Slots)



Special Application on VMC

Features:

- Entire range of horizontal, vertical indexed milling operations can be done with our range of products
- Job Clamping is fast, indexing is quick thereby increasing production efficiency
- Indexing Fixture models covers the advantage of conventional Dividing Head and Rotary Table put together.
- Movable Parts are hardened & Ground for long life
- Indexing accuracy is precise and products can be used on surface grinding also.
- Combination of ball bearings and taper roller bearings on jig bored holes for accurate & easy rotation
- Tail Stock with lead screw movement is provided for center support of long shafts / jobs
- Tail Stock Center is sliding in hardened and accurately ground bushes
- In most models, 24 indexing positions are provided. There is also a graduated collar with 1 deg least count which facilitates odd degree indexing also.
- With all these additional advantages, fixtures are priced much lower than conventional dividing head or rotary table.

PNEUMATIC COLLET FIXTURE

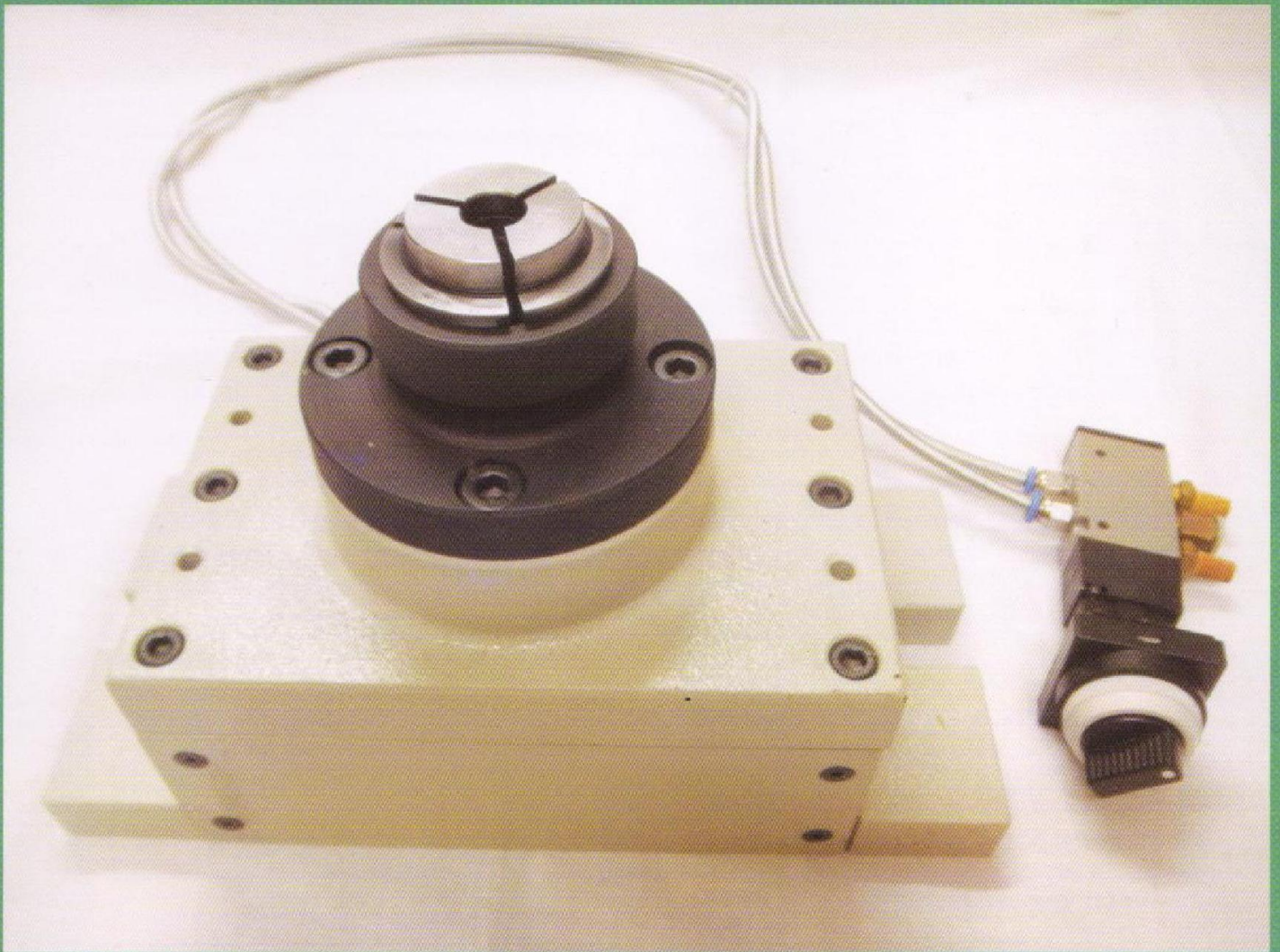

**Ideal for Drilling, Milling, PCD
& Many More Operations**

ADVANTAGES

- **Saves Loading / Unloading Time**
- **Low Cost Automation**
- **Highly Repeatable & Uniform Clamping Force**
- **Concentric Clamping & long Life**
- **Can be Used with Collets Suitable for Various Sizes of Bores and Step Collets**

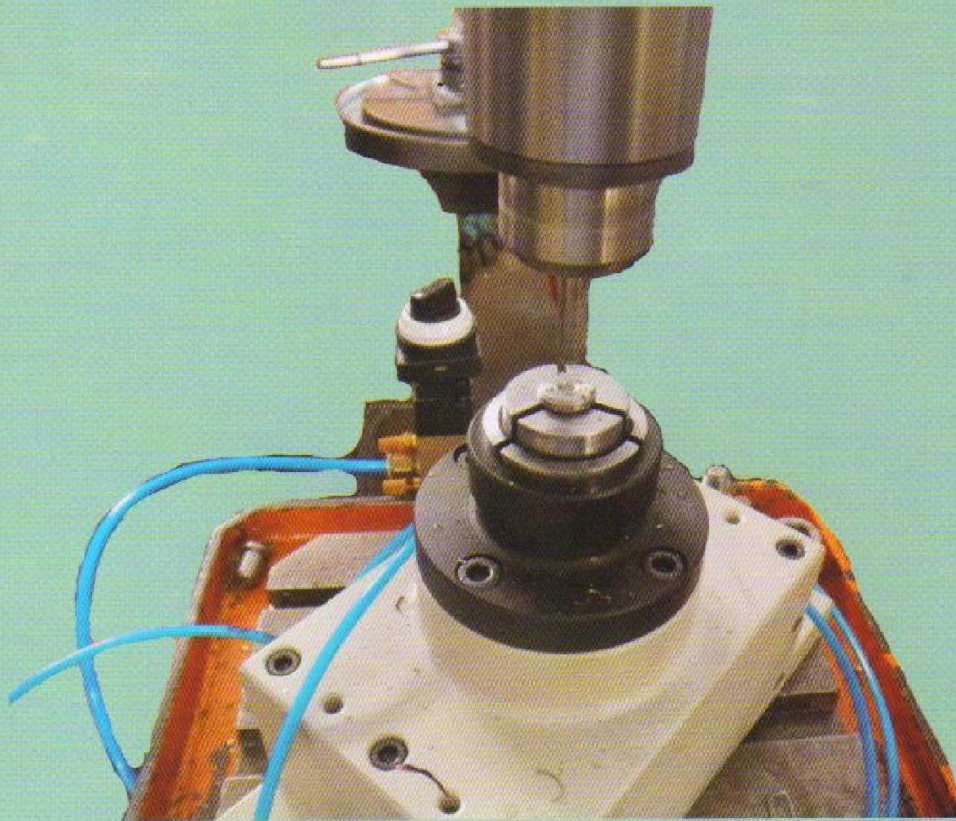

MODELS & SPECIFICATIONS

MODELS	Max. Job Holding Dia	Max. Job Holding Depth
PCFA-25	25 mm	40 mm
PCFA-42	42 mm	60 mm



Dependable Source For Quality Collets



DEADLENGTH COLLETS

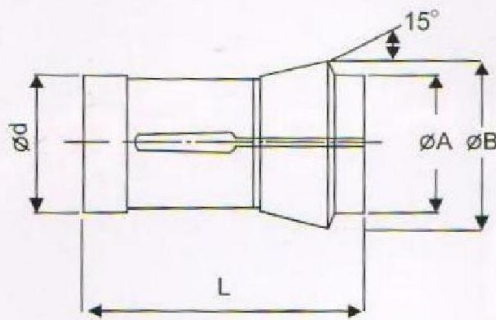

Sr. No.	DIN 6343 Notation	Dimensions				Capacity (Min -max)		
		0d	0B	0A	L	Round	Hex	Square
	Complying With IS 6238							
1	DIN6343-F17.5	17.5	22	16	51	12	10	8
2	DIN6343-F22	22	30	21	55	16	13	11
	DIN6343-F27	27	38.7		72.7	22	19	15
3	DIN6343-F28	28	38	28	70	22	19	15
4	DIN343-F32	32	45	34	75	26	22	18
5	DIN6343-F35	35	48	38	80	30	26	21
6	DIN6343-F42	42	55	42	94	36	30	25
7	DIN6343-F48	48	60	50	94	42	36	29
8	DIN6343-F56	56	68	58	94	50	42	35
9	DIN6343-F66	66	84	73	110	60	52	42
10	DIN6343-F90	90	107	90	130	80		

SPECIFICATIONS REGARDING MATERIAL, HEAT TREATMENT CONCENTRICITY & ACCURACY

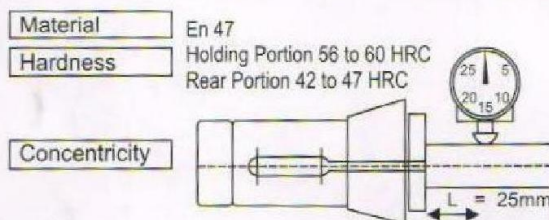

Sr. No.:	Range of Diameter or Width Across Flat (For Square and Hex)		Runout of Collet Bore		
	Over	Upto	Circular (D)	Square (S)	Hex (SI)
1)	4	6	0.02	0.04	0.04
2)	6	10			
3)	10	18	0.03	0.05	0.05
4)	18	24			
5)	30	50	0.04	0.06	0.06
6)	50	Above			

DRAW - TYPE COLLETS

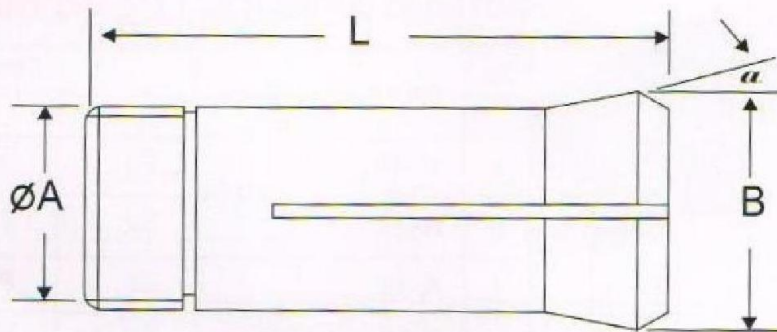

Sr. No.	IS / DIN 6343/OTHER NOTATION	Dimensions					Capacity (max)
		A	Thread	L	B	α	Round
1	5 C	31.75	ϕ 31.5 x 20 TPI	85.4	37.3	10°	25.4
2	16 C	48	ϕ 47.5 x 1.75	109.5	57.4	10°	42.5
3	3 J	50.8	ϕ 50.5 x 20 TPI	95.25	55.9	7°	44.45

DIN 6499 - ER Collet

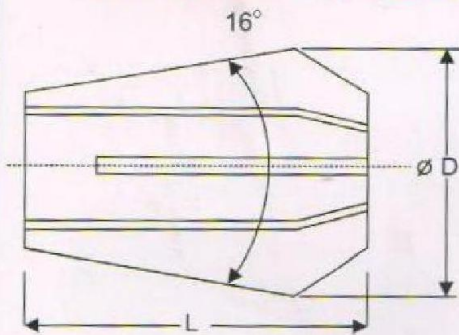

Sr. No.	Description	Dimensions		Capacity (min-Max)
		D	L	Round
1	ER8	8.5	13.5	5
2	ER11	11.5	18	7
3	ER16	17	27	10
4	ER20	21	31	13
5	ER25	26	35	16
6	ER32	33	40	20
7	ER40	41	46	26
8	ER50	52	60	36
				Collapse-0.5/1 mm

ER COLLET CONCENTRICITY-PER DIN 6499

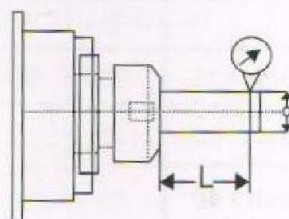

Clamping Range D		L	Maximum T.I.R.	
Min	Max		Precision DIN 6499	High Precision DIN 6499
1.0	1.6	6	0.015	0.008
1.6	3.0	10		
3.0	6.0	16		
5.0	10.0	25	0.020	0.010
10.0	18.0	40		
18.0	26.0	50		
26.0	34.0	60	0.025	

COLLETS FOR VARIOUS MACHINES

SINGLE SPINDLE TRAUB AUTOMAT COLLETS

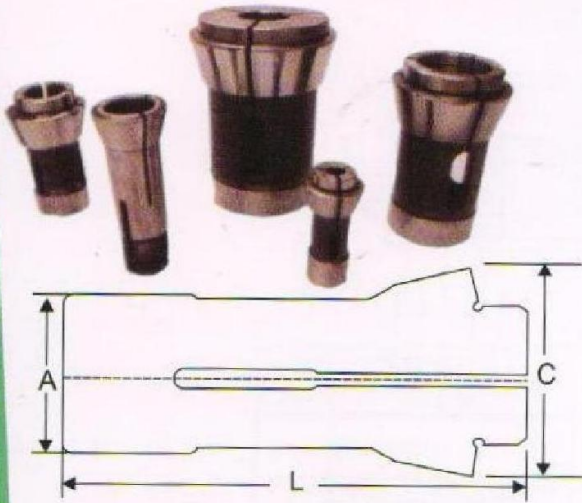

Sr. No.	PART No. / Model	Dimensions			Capacity maximum
		A	L	C	
1	A-15	22	55	30	15
2	A-25	32	75	45	25
3	A-30	35	80	48	30
4	A-32	38	108	50	32
5	A-42	48	94	60	42
6	A-60	66	110	84	60

TRAUB DRILL COLLET SPECIFICATIONS

Sr. No.	PART No. / Model	Dimensions		
		A	B	C
1	A-25	11.5	55	21.5
2	A-42	23	87	33

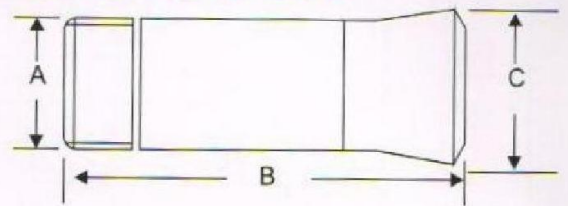

REDUCTION BUSHES FOR BORING BARS

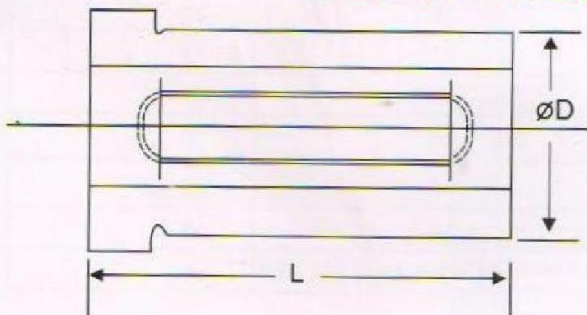

No.	Description	Dimensions		Capacity (Min-Max)
		D	L	
				Round
1	Reduction Bush - 25	25	50	6-20
2	Reduction Bush - 32	32	70	6-25
3	Reduction Bush - 40	40	80	6-32

WICKMAN COLLETS

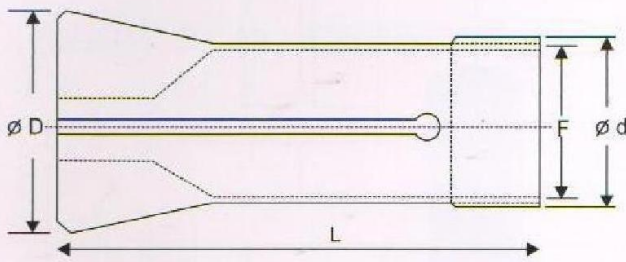

No.	Description	$\varnothing d$	$\varnothing D$	F	L	Capacity (Min-Max)		
						Round	Hex	Square
1	5/8"	29.4	38.1	1 1/32" x 24 BSW, LH	92	16	13.5	11.5
2	1"	41.3	54.5	1.486" X 24 USS, LH	132	25.4	22.2	18
3	1 3/8"	55.47	67	2" X 22 BSW	117	35	30	24.6
4	1 3/4"	64.21	78.5	2 3/8" X 16 BSW	127	44.5	38.0	32.0
5	2 1/4"	76.86	95.5	2.85" X 22 BSW	181	50.8	43.6	35.7
6	2 5/8"	92.07	111	2 7/8" X 24 USF, LH	165	66.6	57.1	46.8

WICKMAN - FEED FINGERS

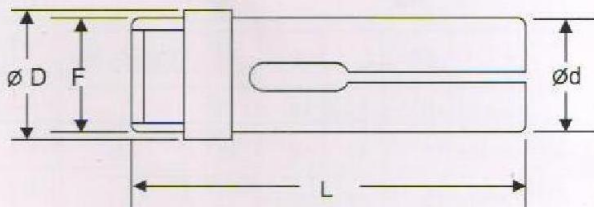

No.	Description	$\varnothing d$	$\varnothing D$	F	L	Capacity (Min-Max)		
						Round	Hex	Square
1	5/8"	21.6	21.6	0.775" x 24 BSW	86	16	13.5	11.5
2	1"	30.9	31.9	30 X 24 USS, LH	133	25.4	22.2	18.0
3	1 3/8"	41.5	42.84	1 19/32" X 22 BSW, LH	118	35	30	24.6
4	1 3/4"	51.5	52.21	50 x 22 BSW, LH	127	44.5	38	32
5	2 1/4"	64.3	65.1	2 15/32" X 22 BSW, LH	171	50.8	43.6	35.7
6	2 5/8"	74.6	75.6	2 7/8" X 24 USF, LH	179	66.6	57.1	46.8

SCHAUBLIN DEAD LENGTH COLLET

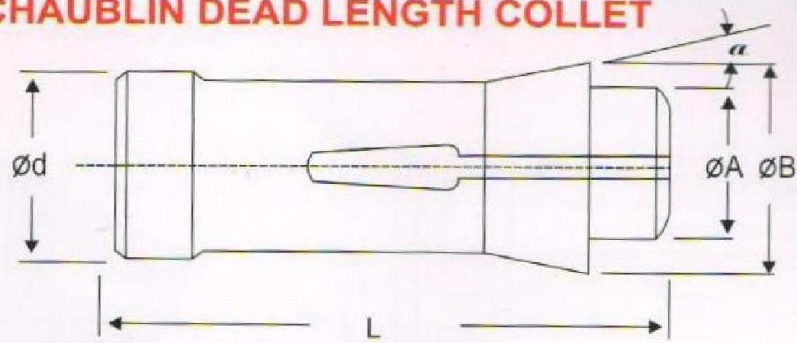

Sr. No.		Dimensions				α	Capacity (Min-Max)		
		$\varnothing d$	$\varnothing B$	$\varnothing A$	L		Round	Hex	Square
1	F22	22	30	21	55	15	17	12	14.5
2	F25	25	35	27	77	16	21	15	18
3	F27	27	38	30	72.7	15	23	16	20
4	F30	30	42	34	80	16	26	18	22
5	F32	32	45	34	75	15	27	19	23

SCHAUBLIN PULL TYPE COLLET

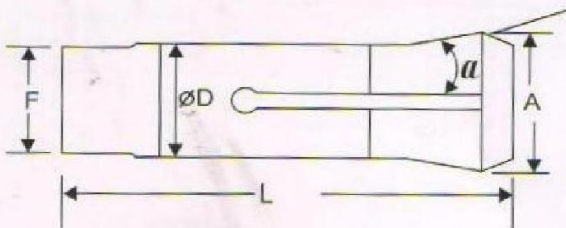

No.	Description	F	$\varnothing D$	L	A	α	Capacity Max
1	W10	$\varnothing 9.83 \times 0.833$ Angle 45deg / 5 deg Buttress	10	43.6	14	15	6.7
2	W12	$\varnothing 11.75 \times 1.25$ Angle 45deg / 5 deg Buttress	12	46	16	15	8.0
3	W15	$\varnothing 14.75 \times 1.25$ Angle 45deg / 5 deg Buttress	15	58.3	20.2	15	10.7
4	W20	$\varnothing 19.7 \times 1.66$ Angle 45deg / 5 deg Buttress	20	73	26.3	15	14.5
5	W25	$\varnothing 24.7 \times 1.7$ Angle 45deg / 5 deg Buttress	25	94	33.8	15	19
6	W31.75	$\varnothing 31.4 \times 20$ TPI-USF	31.75	87	37.4	10	25.4
7	B15	M13X1	15	55	21	20	9.5
8	B32UP	M30X1.5	32	102	40	15	24
9	B32	$\varnothing 29.7 \times 15$ TPI Angle 45deg / 5 deg Buttress	32	106	40	15	24
10	B45	M42X1.5	45	115	53	15	36
11	P10	Internal Thread	10	39	14	15	5.7

ON request collets for various other multi-spindle automats like

- Gildemeister
- Citizen

- Herbert
- Pittler and many more

BALL CAGES (BRASS/ALLUMINIUM)

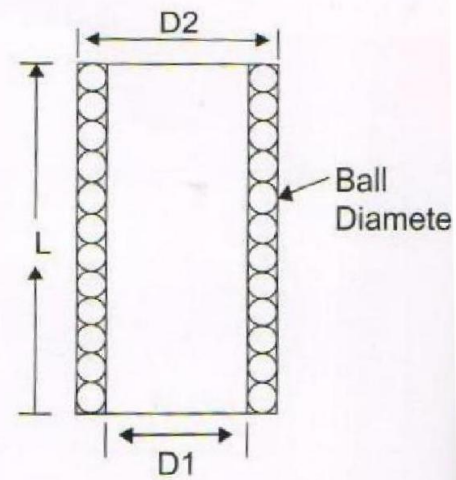

No.	Pillar Diameter (mm) (D1)	Bush Diameter (mm) (D2)	Ball Diameter (mm)	Length (mm) (L)
1	18	24	3	65
2	20	26	3	65
3	20	26	3	80
4	24	30	3	65
5	24	32	4	80
6	25	31	3	65
7	25	33	4	65
8	25	33	4	80
9	28	36	4	80
10	28	36	4	100
11	30	38	4	80
12	30	38	4	100
13	32	40	4	80
14	32	40	4	100
15	34	42	4	80
16	34	42	4	100
17	36	44	4	80
18	36	44	4	100
19	40	48	4	80
20	40	48		100

SPECIAL BALL CAGES AS PER CUSTOMER'S REQUIREMENT ALSO CAN BE SUPPLIED

SPECIAL / IMPORT SUBSTITUTION COLLETS



A25 - Round - Eccentric - Hex



Automation Collets



CNC - Special Collet



Collets CKS



Collets for Automated Valve Mfg



Double End Collets for Valve Industry



Guide Bush Collet



Collets for PCB Manufacture



ID Holding Expanding
Mandrel Collet



Kitamura - Pull Stud Collet



Split Bush



HMC - Pull Stud Collets